

**NOTE:** If the unit is to be located in the attic and installed through the ceiling joists, attach the supply plenum in the attic.

### A. HORIZONTAL DISCHARGE: Refer to Figure 1

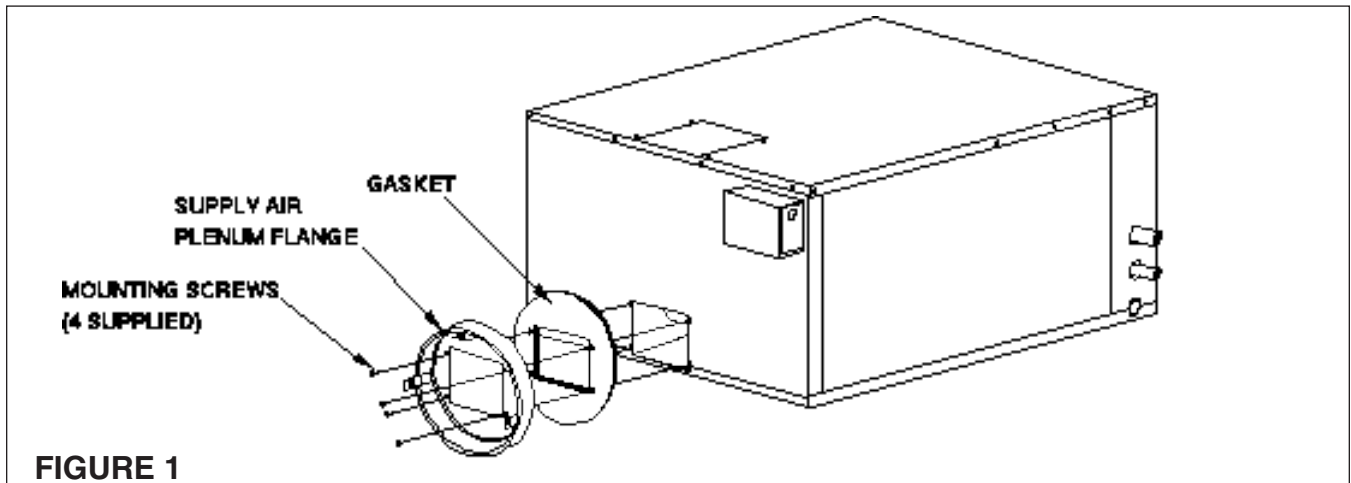

**FIGURE 1**

### B. VERTICAL DISCHARGE: Refer to Figure 2A & 2B (Requires Field Conversion)

Tools required:  $\frac{5}{16}$ " box wrench,  $\frac{5}{16}$ " nut driver, drill and  $\frac{1}{4}$ " drill bit.

Refer to Figure 2A for Steps 2 to 5a.

1. Place unit horizontally on a flat surface.
2. Remove side access panels, the cover plate from the top panel and top of unit.
3. Remove the two screws securing the front panel flange to the blower housing.
4. Remove the two screws attaching the blower housing to the motor support channel flange.
- 5a. Remove the six (6) screws attaching the motor mounting base to the motor support channel.

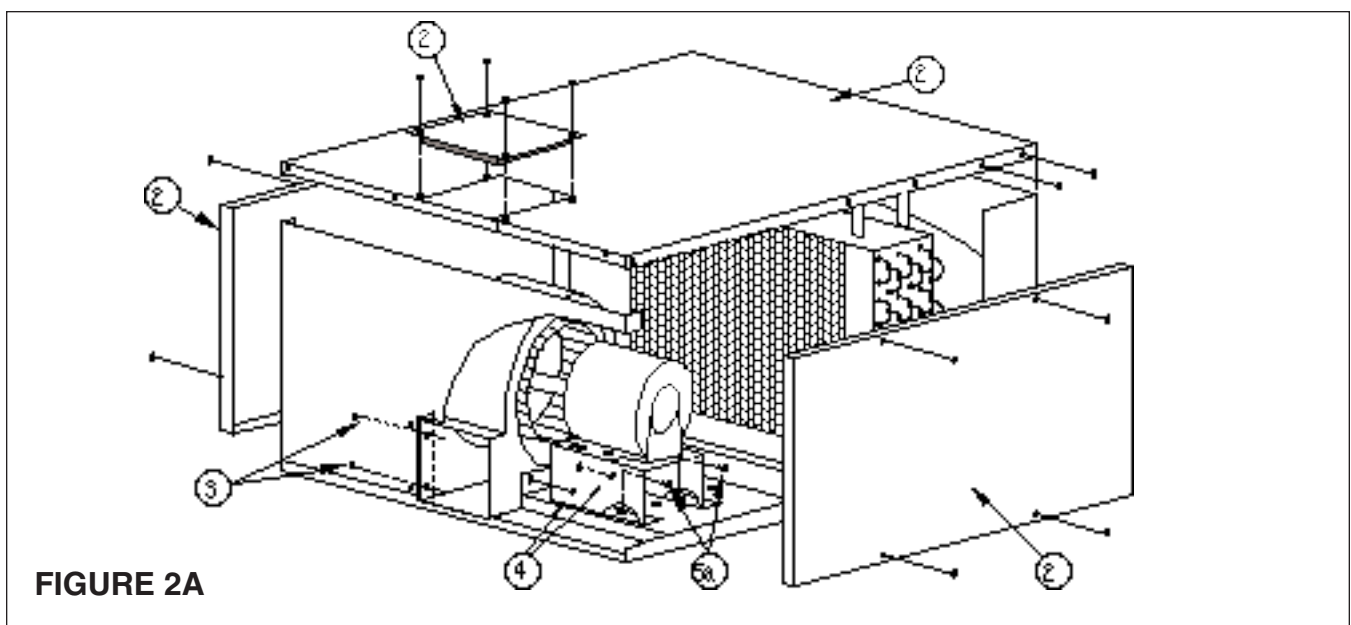

**FIGURE 2A**

Refer to Figure 2B for Steps 5b to 14.

- 5b. Shift the motor mounting base (and blower housing) back towards the coil to the second set of mounting lugs on the motor support channel. When in position, reattach the motor mounting base to the motor support channel with the six screws.
  6. Rotate the blower housing 90° to face upwards. Align the hole in the side blower housing with the upper slot in the motor support channel flange and join the two parts with one of the previously removed screws.
  7. Attach the two flanges supplied, one to each side of the blower housing outlet. Align the holes in the flange with the holes in the housing and attach with screws supplied.
  8. Drill out the four (4) screw holes in the top panel securing the removed cover plate to ¼" diameter.
  9. Make a 2" long cut in the top panel insulation from each corner of the opening toward the sides of the unit to prepare for **Step 11**.
  10. Reposition the top panel on the unit **taking care** to straddle the evaporator coil with coil support brackets and to replace all screws.
  11. Fold back the top insulation flaps created in **Step 9** and position the flanges on the blower housing discharge against the top panel. Place the supply plenum flange over the opening. Align the holes in the flange, gasket and top panel with the blower housing flange holes and secure with the screws provided. Reposition the top insulation flaps over the blower housing flanges. The insulation must be in place to prevent condensation forming on the top panel.
  12. Check that the blower wheel is centered in the inlet and discharge of the blower housing. To make any adjustments, loosen the 4 bolts securing the motor, shift the motor as required and refasten the 4 bolts.
  13. Place the coverplate removed from the top panel over opening in the front panel and screw in place.
- NOTE: Check that all inside cabinet surfaces are covered with insulation. Add insulation if required. An uninsulated panel will "sweat" and condensate will form on the cabinet.**
14. Replace the side access panels.

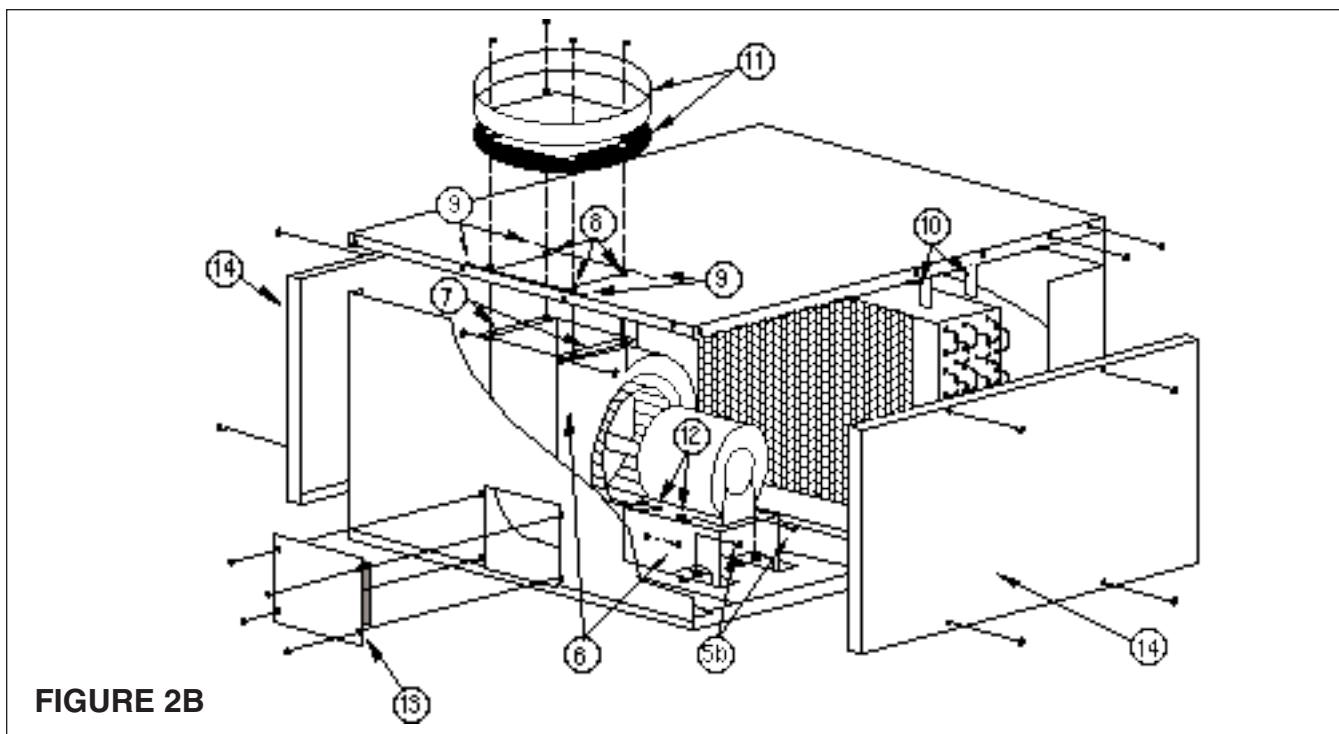

FIGURE 2B